

SHIMANO ULTEGRA Dual Control Lever
ST-6510 FLIGHT DECK Compatible

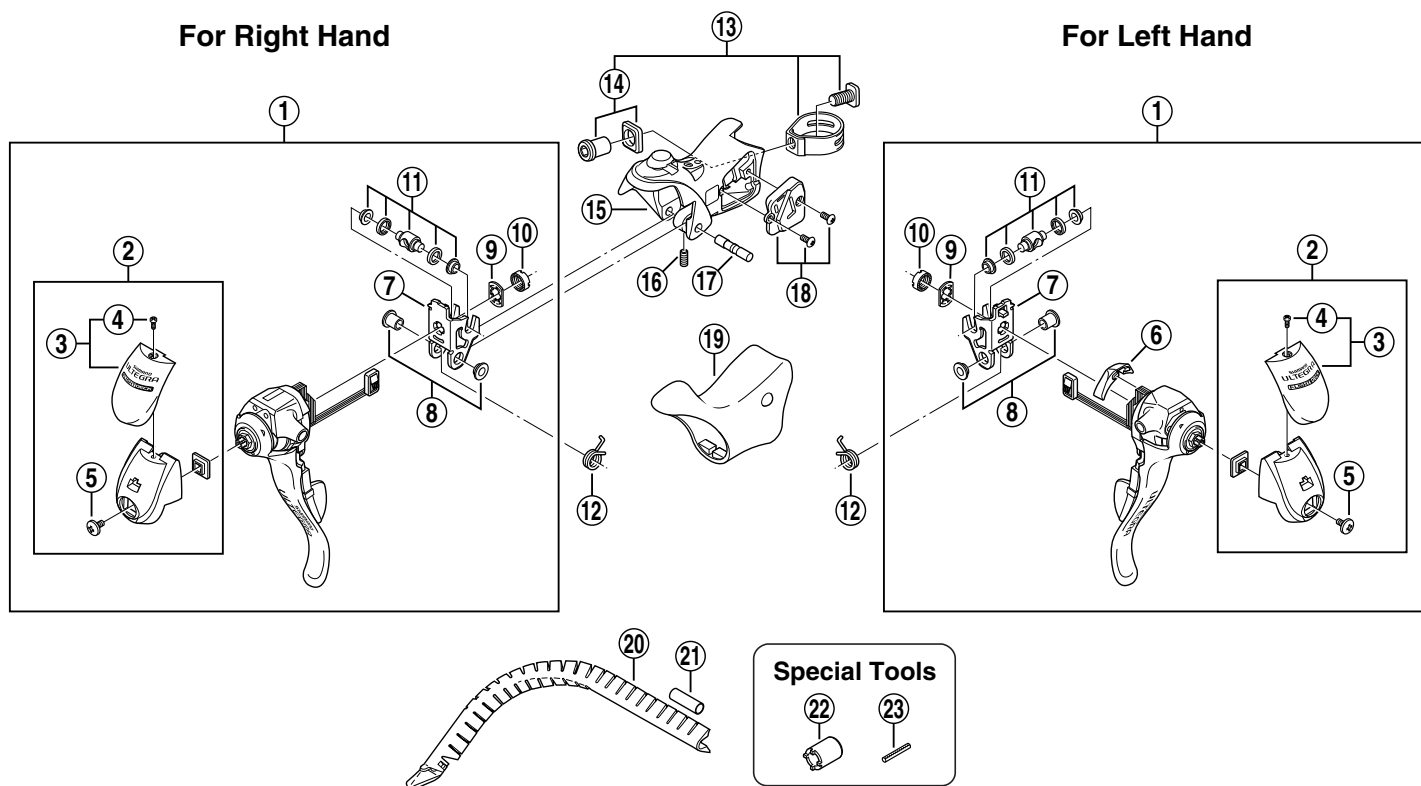

Q'TY	ITEM NO.	SHIMANO CODE NO.	DESCRIPTION
	1	Y-6C8 98010	R.H. Main Lever Assembly
		Y-6C8 98020	L.H. Main Lever Assembly
	2	Y-6C8 98040	R.H. Front Cover Unit
		Y-6C8 98050	L.H. Front Cover Unit
	3	Y-6C8 98030	Name Plate & Fixing Screw
	4	Y-6C8 50000	Name Plate Fixing Screw
	5	Y-6CU 13000	Front Cover Fixing Screw (M3 x 6)
	6	Y-6BS 71000	L.H. Rear Cover
	7	Y-6CT 03000	R.H. Adapter
		Y-6CT 03010	L.H. Adapter
	8	Y-85Z 98010	Lever Axle Bush Unit
	9	Y-6BD39000	Non-Turn Washer
	10	Y-66E 33000	Lock Nut
	11	Y-6BD98110	Cable Hook Unit
	12	Y-6BD75000	R.H. Return Spring
		Y-6BD74000	L.H. Return Spring
	13	Y-6BD98120	Clamp Band Unit (φ23.8 mm – φ24.2 mm)
	14	Y-6BD98130	Clamp Nut & Washer
	15	Y-6C8 98060	R.H. Bracket
		Y-6C8 98080	L.H. Bracket
	16	Y-6BD76000	Lever Axle Fixing Screw
	17	Y-6BS 84000	Lever Axle
	18	Y-6CT 98080	R.H. Bracket Cap & Fixing Screws (M3 x 6.35)
		Y-6CT 98090	L.H. Bracket Cap & Fixing Screws (M3 x 6.35)
	19	Y-6C8 98070	Bracket Covers (Pair)
	20	Y-86B 90010	Outer Cable Guide
	21	Y-877 11000	Outer Cable Joint
	22	Y-130 03000	Lock Nut Removal Tool (TL-ST01)
	23	Y-130 03100	Return Spring Installation Tool (TL-ST02)