

Brake Lever

BL-M765 For Disc Brake

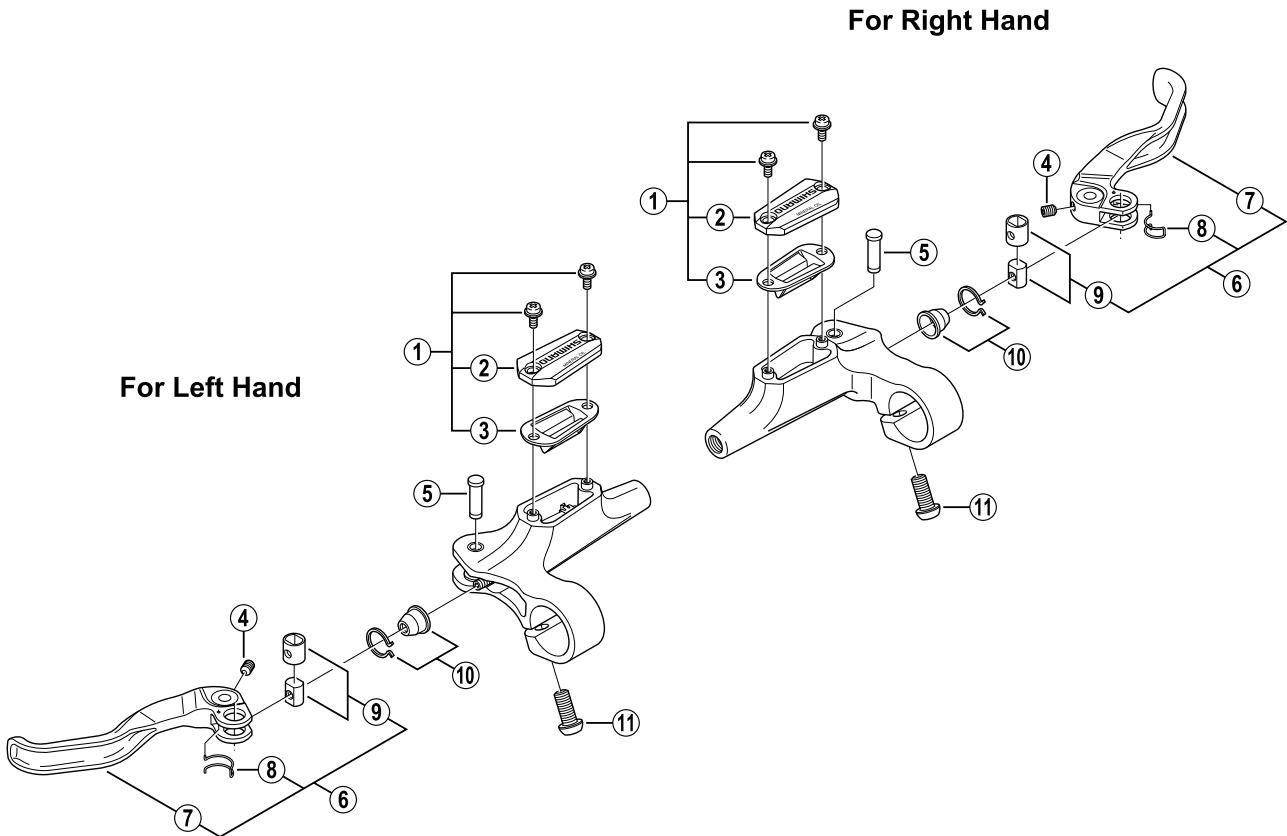

ITEM NO.	SHIMANO CODE NO.	DESCRIPTION
1	Y-8S4 98040	R.H. Lid Unit
	Y-8S4 98020	L.H. Lid Unit
2	Y-8S4 07010	R.H. Lid
	Y-8S4 07110	L.H. Lid
3	Y-8S1 06000	Diaphragm
	Y-6AU84000	Lever Axle Fixing Bolt (6 mm)
4	Y-8SY 98040	Lever Axle
5	Y-8S5 98070	Lever Unit
6	Y-8SZ 05400	Lever Member
7	Y-8SY 13000	Boss Spring
8	Y-6JK 98070	Reach Adjusting Boss & Sleeve
9	Y-8SY 98070	Boot & Stopper
10	Y-8SB 10000	Clamp Bolt (M6 x 14.8)
11		

0506-2485