

SHIMANO DX SPD Pedals PD-M646

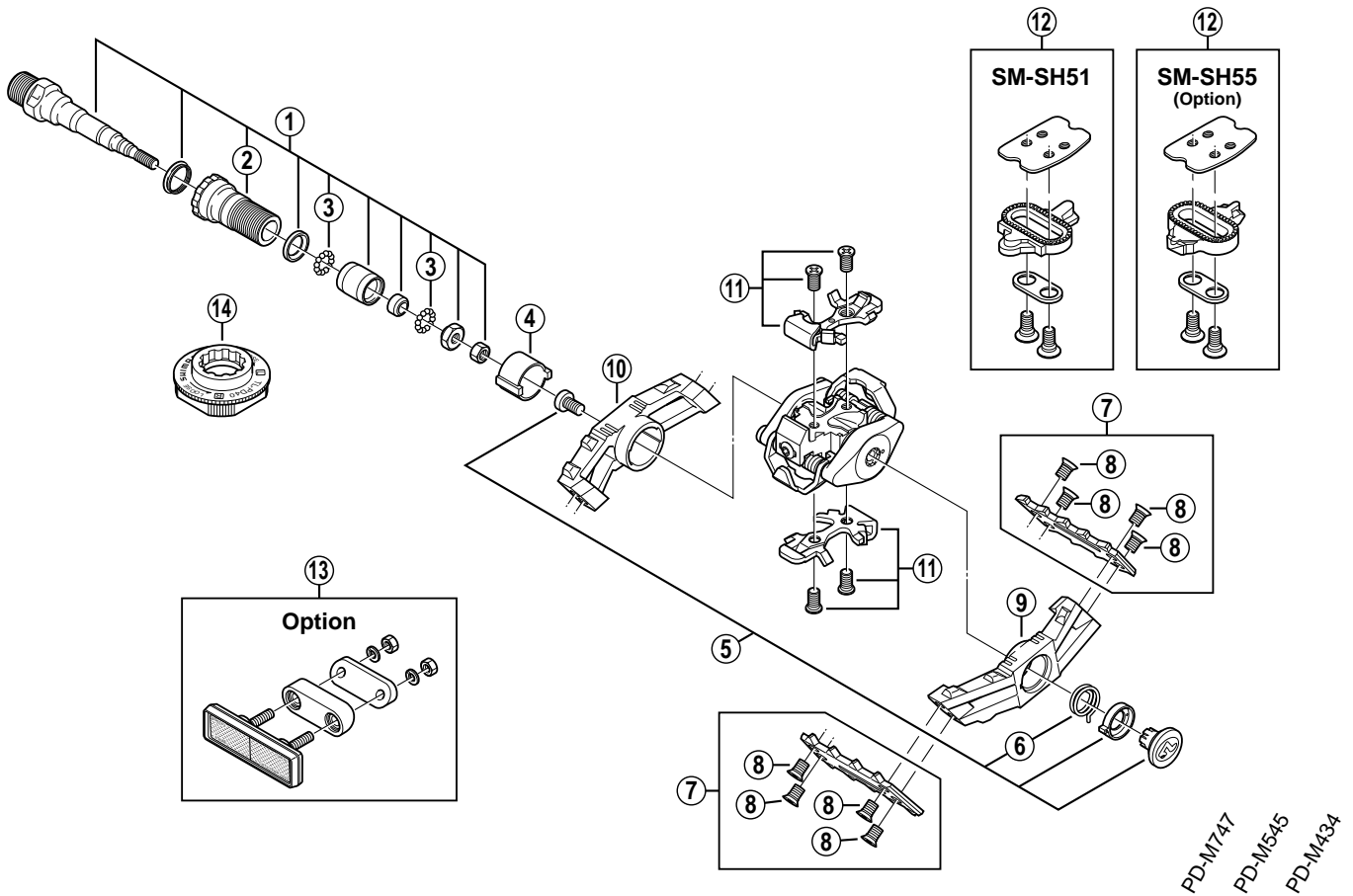

ITEM NO.	SHIMANO CODE NO.	DESCRIPTION	INTERCHANGEABILITY
1	Y-43Z 98010	Pedal Axle Assembly (Right / B.C. 9/16" x 20T.P.I)	A A A
	Y-43Z 98020	Pedal Axle Assembly (Left / B.C. 9/16" x 20T.P.I)	A A A
2	Y-43Z 13000	Lock Bolt (Right)	A A A
	Y-43Z 14000	Lock Bolt (Left)	A A A
3	Y-000 91610	Steel Ball (3/32") 60 pcs.	
4	Y-41L 11000	Sleeve	
5	Y-41L 98010	Cap Unit (Right)	
	Y-41L 98020	Cap Unit (Left)	
6	Y-41F 05000	Frame Spring (Right)	A A
	Y-41F 06000	Frame Spring (Left)	A A
7	Y-41L 98030	Plate Unit (Right)	
	Y-41L 98040	Plate Unit (Left)	
8	Y-41L 12000	Plate Fixing Bolt	
9	Y-41L 05000	Outside Frame (Right)	
	Y-41L 06000	Outside Frame (Left)	
10	Y-41L 07000	Inside Frame (Right)	
	Y-41L 08000	Inside Frame (Left)	
11	Y-41C 98011	Body Plate & Fixing Screws (M5)	A A A
12	Y-424 98200	SM-SH51 Cleat Set (Single Release Mode / Pair)	A A A
	Y-424 98300	SM-SH55 Cleat Set (Multiple Release Mode / Pair)	A A A
13	Y-41L 98050	Reflector Unit (4 pcs. / Option)	
14	Y-42A 09000	TL-PD40 Special Tool	A A A

The table indicates the adaptability of conventional parts to PD-M646.

A : Same parts.

Absence of mark indicates non-interchangeability.

9905-1854

Specifications are subject to change without notice.

SHIMANO